



User Manual

TL200

TL200 Fingerprint Lock With Voice Guide Feature

Version: 1.0

Date: Aug., 2016

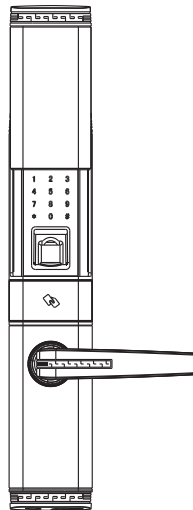

Content

Read Before Use	1
Safety Caution.....	1
Structure.....	2
Basic Function	3
User Introduction.....	3
Operation and Voice Prompt.....	4
Initialization.....	4
Random Password.....	5
Voice Guide.....	5
Normal Open.....	6
User Data Synchronization.....	6
Low Battery Alarm.....	6
Anti Break-in Alarm.....	7
Security Deabort.....	8
9V External Battery.....	8

Emergency Mechanical Key.....	9
How To Use.....	10
Register First Administrator.....	10
Register Other Administrators.....	11
Register Normal User.....	13
Delete by User Number.....	15
Delete Administrator Group.....	16
Delete Normal User Group.....	17
Supplemental Register.....	18
Upload User Data.....	19
Download User Data.....	20
Enable Normal Open.....	21
Optional Function.....	22
Remote Control ★.....	22
Quick Start.....	24
Open the Door With Fingerprint.....	24

Open the Door With Password.....24

Open the Door With Card.....24

Read Before Use

Safety Caution

1. The factory setting for all new locks can be opened by ANY fingerprints.
2. Please register at least one administrator for the new installed lock. The lock cannot register any normal users without an administrator.
3. The lock is equipped with mechanical keys for manually unlocking. Please keep the mechanical keys in the safe place.
4. To power on the lock, eight alkaline AA batteries (not included) are required.
Non-alkaline and rechargeable batteries ARE NOT RECOMMENDED.
5. Do not remove batteries when the lock is in working state.
6. Please replace the battery soon when the lock prompts the voice of low battery.
7. There are 7 seconds stand-by time limits for all setting operations, without any activity within the time limits, the lock will automatically shut off.
8. Keep your fingers clean when using this lock.

Structure

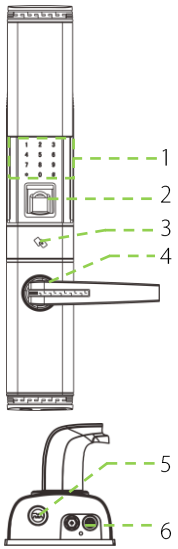

- 1 Keypad Area
- 2 Fingerprint Sensor
- 3 Card Detection Area
- 4 Handle
- 5 Mechanical Key Hole
- 6 9V battery Interface
- 7 Battery Area
- 8 USB Port
- 9 Reset Button
- 10 Pairing Button
- 11 Indicator Light
- 12 Manual Knob

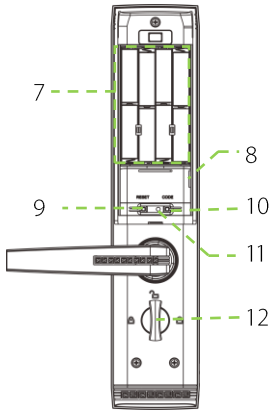

Basic Function

User Introduction

User	Verification Mode	Function
Administrator	Fingerprint	Menu Operation, Open The Door
	Password	
	ID Card	
Normal User	Fingerprint	Open The Door
	Password	
	ID Card	

- Note:** 1) The maximum capacity of fingerprint or password or ID card is 100.
2) The length of password is 6 digits.

Operation and Voice Prompt

Operation	Voice Prompt
Verification Succeed	"Thank you"
Verification Failed	"Verification Failed"
Registration Succeed	"Registered"
Deletion Succeed	"Deleted"
Registration Failed	"Operation Failed"
Fingerprint has already registered	"This fingerprint is already used"
Password has already registered	"This password is already used"
ID Card has already registered	"This card is already used"
User Number has already registered	"This user number is already used"

Initialization

Initializing the lock means all data will be deleted and restored to factory default setting.

Operation Instruction: Press the reset button, then touch the keypad to power on the

lock, and holding the reset button for 5 seconds until the lock prompts the voice of “Restore to default settings, wait a moment”. After around 30 seconds, the lock prompts the voice of “completed”, and then the initialization is finished completely.

Random Password

Random password = random digits + correct password + random digits.

Users may enter any random digits in front of and behind the correct password to create random password to open the door. The maximum length of the random password is 32 digits.

For example: If the correct password is 123456, the random password can be 891123456807, 1234562363, 3891123456, etc.

Voice Guide

After access into the menu, the lock will prompt voice before and after each operation. It is quite easy for user to know how to operate each step.

Normal Open

Normal open mode is to keep lock always unlocked, which is fit for meeting room and some places free to in or out.

User Data Synchronization

The user data can be downloaded/uploaded via U-disk from one lock to other locks, it will help users to save time in some repeated registrations.

Low Battery Alarm

When the lock is in low battery status, it will trigger the alarm with the sound of short beep and the voice of "Battery is low, please replace". After triggering low battery alarm, the lock will be out of battery in approx. 200 operations.

Note: Access to operation steps is not allowed in low battery status.

Anti Break-in Alarm

The anti break-in alarm is closed at default. Push switch inside the front lock to turn on the alarm. After that, when the front lock is disassembled forcibly from the door, it will trigger the alarm with three “short beeps” constantly.

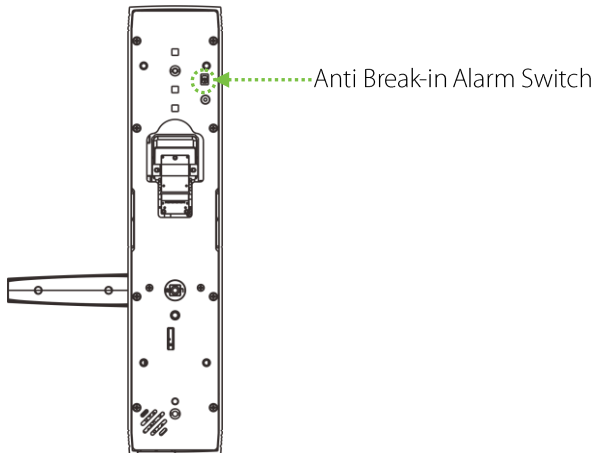

Security Deabolt

The mortise of this lock has two security deadbolt, one is big deadbolt that is used to lock the door from both outdoor and indoor, the other is small deadbolt that is used to lock the door from indoor.

9V External Battery

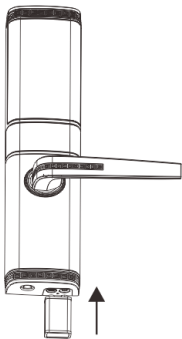

9V external battery is used to open door when the lock is out of battery.

Note: The above battery must be 9V alkaline battery (6LR61).

Emergency Mechanical Key

The mechanical key is used to open door when the lock has electronic malfunction.

Note: Keep the mechanical key in a safe place.

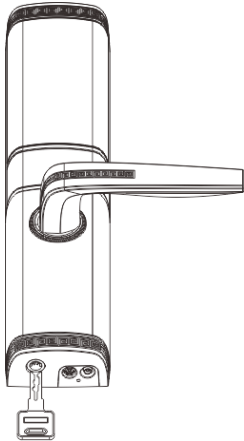

Insert the key into key hole and rotate 90° , then press down the handle to open the door.

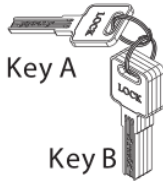

Mechanical Key Instruction:

1. Key A is coated with brass color, which is used only for lock installer and upfitter.
2. Key B is packed in the sealed plastic wrap for safety, which is used for house owner.
3. Once Key B is used, Key A will be disabled to open the lock.

How To Use

Register First Administrator

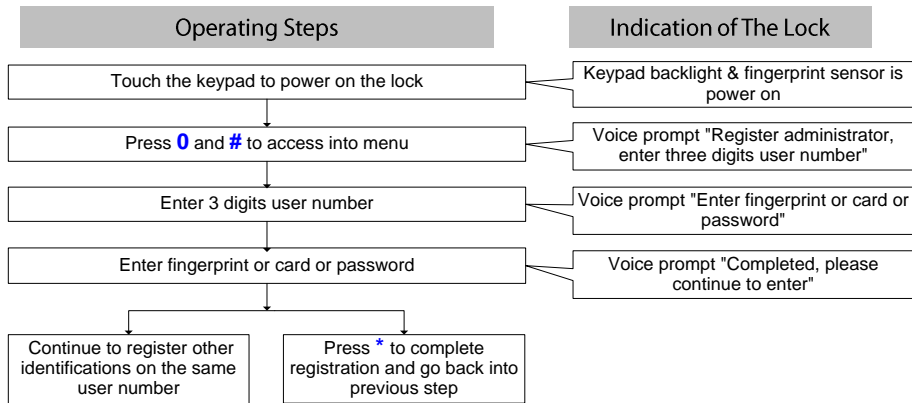

Note: 1) Place one finger 3 times on fingerprint sensor to register fingerprint.

2) The length of password is 6 digits.

3) The regular length of user number is 3 digits. However, it is also correct to enter 1 digit or 2 digits with the end of **#** as the user number. For example, **001** is equal to **1#** or **01#**.

4) Press ***** to cancel registration before register is complete.

Register Other Administrators

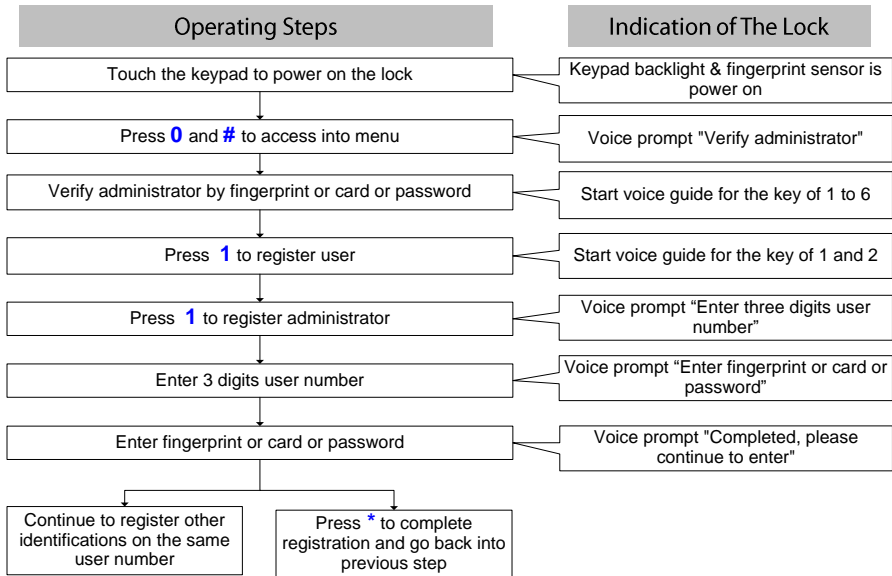

- Note:**
- 1) Place one finger 3 times on fingerprint sensor to register fingerprint.
 - 2) The length of password is 6 digits. When verify administrator by password, press # to end.
 - 3) The regular length of user number is 3 digits. However, it is also correct to enter 1 digit or 2 digits with the end of # as the user number. For example, **001** is equal to **1#** or **01#**.
 - 4) Press * to cancel registration before register is complete.

Register Normal User

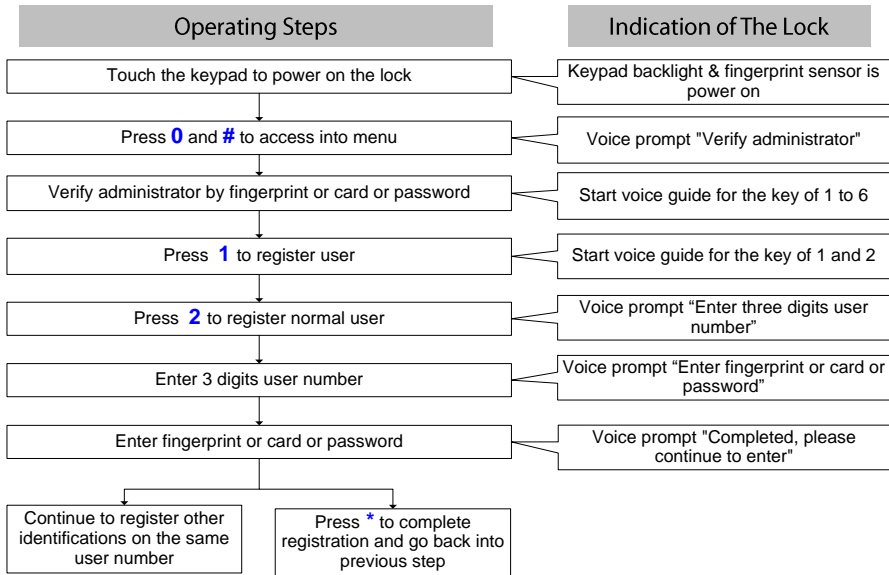

- Note:**
- 1) Place one finger 3 times on fingerprint sensor to register fingerprint.
 - 2) The length of password is 6 digits. When verify administrator by password, press # to end.
 - 3) The regular length of user number is 3 digits. However, it is also correct to enter 1 digit or 2 digits with the end of # as the user number. For example, **001** is equal to **1#** or **01#**.
 - 4) Press * to cancel registration before register is complete.

Delete by User Number

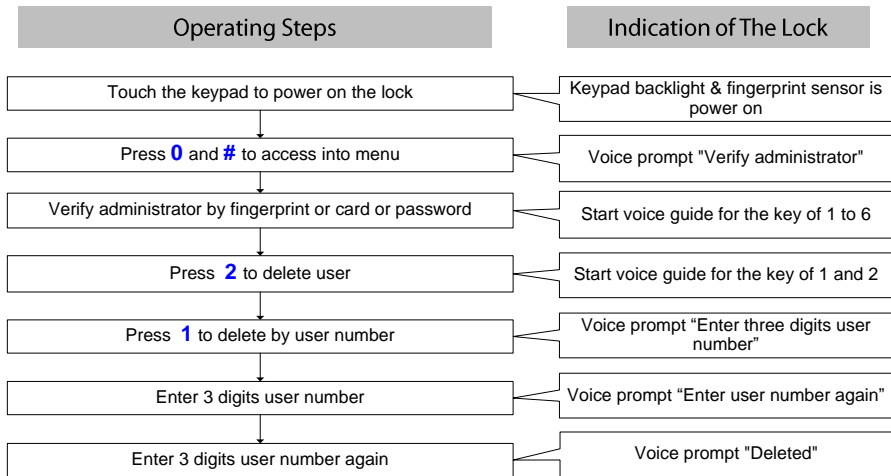

- Note:** 1) The regular length of user number is 3 digits. However, it is also correct to enter 1 digit or 2 digits with the end of **#** as the user number. For example, **001** is equal to **1#** or **01#**.
- 2) When verify administrator by password, press **#** to end.
- 3) Press ***** to cancel registration before register is complete.

Delete Administrator Group

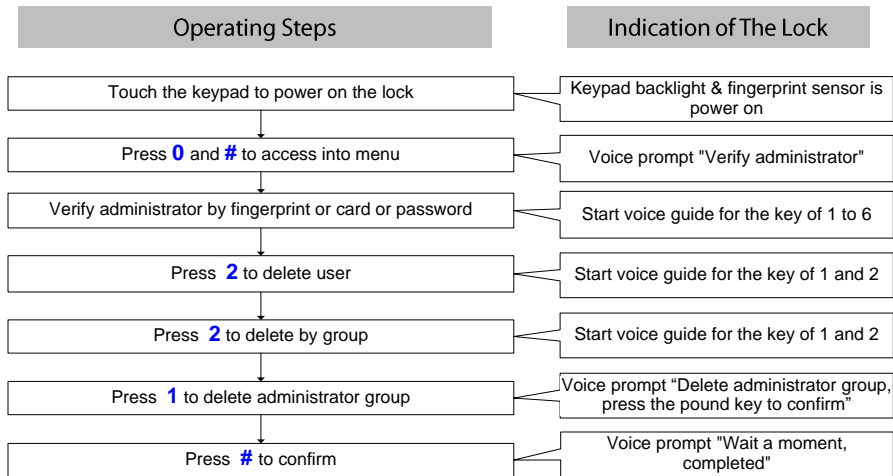

Note: 1) When verify administrator by password, press **#** to end.

2) Press ***** to cancel registration before register is complete.

Delete Normal User Group

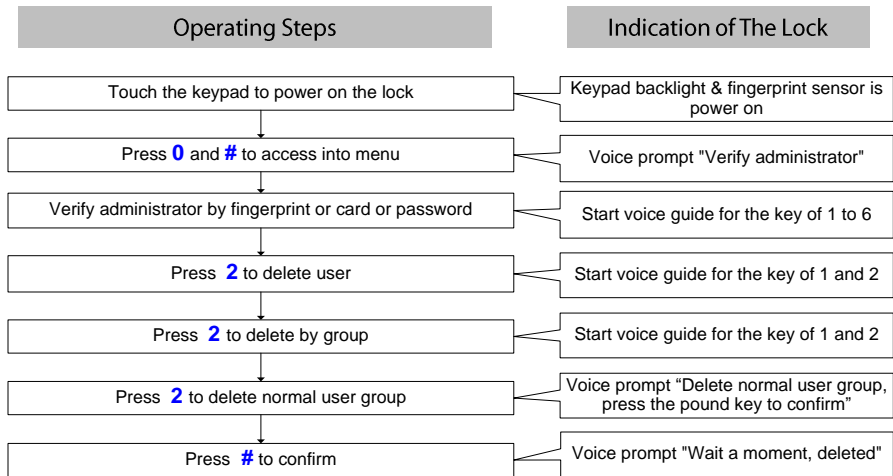

- Note:** 1) When verify administrator by password, press **#** to end.
2) Press ***** to cancel registration before register is complete.

Supplemental Register

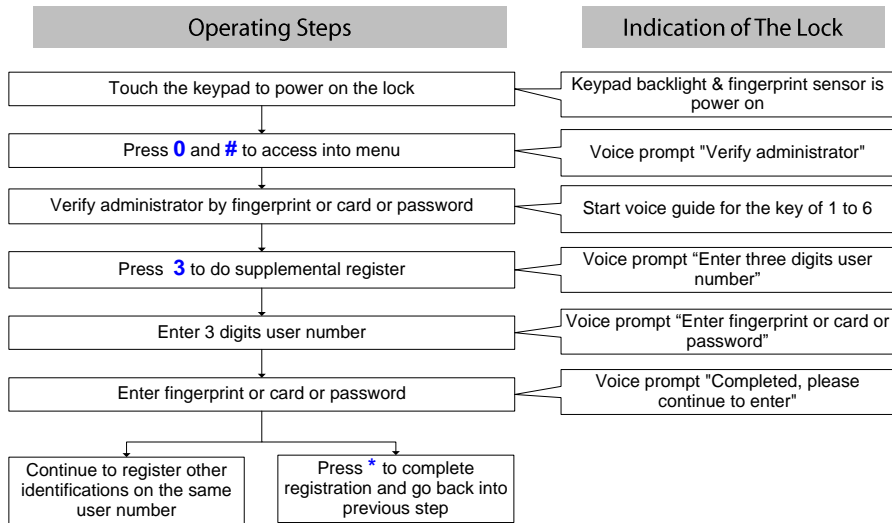

- Note:** 1) The regular length of user number is 3 digits. However, it is also correct to enter 1 digit or 2 digits with the end of **#** as the user number. For example, **001** is equal to **1#** or **01#**.
- 2) When verify administrator by password, press **#** to end.

Upload User Data

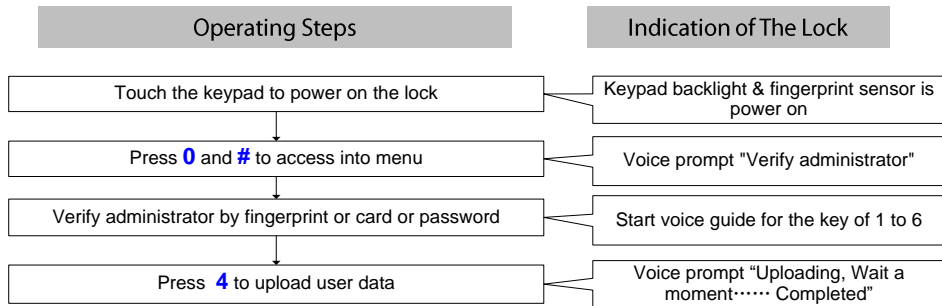

Note: 1) Please insert U-disk at first before above operations.

2) When verify administrator by password, press **#** to end.

Download User Data

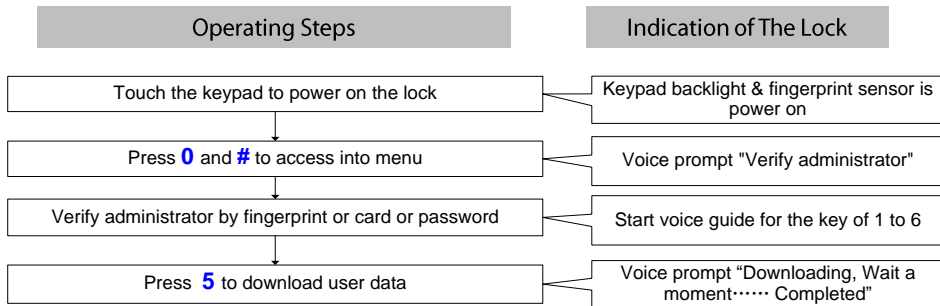

Note: 1) Please insert U-disk at first before above operations.

2) When verify administrator by password, press **#** to end.

Enable Normal Open

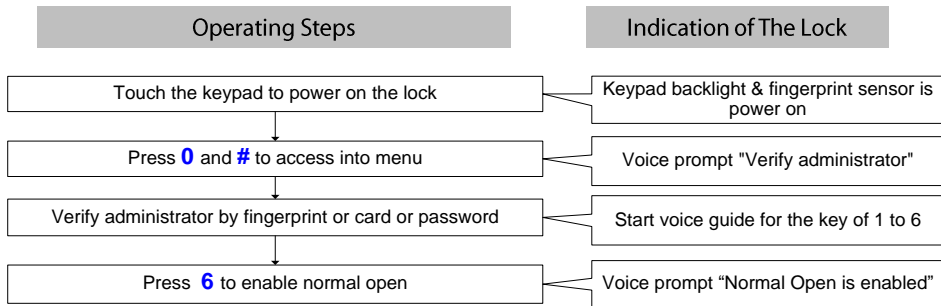

Note: 1) To disable normal open, please use any registered fingerprint / card / password to unlock the door.

2) When verify administrator by password, press **#** to end.

Optional Function

Remote Control ★

Remote Control is an optional function. One remote control device is included in the lock package. A maximum of 4 remote control devices can be registered. Please purchase separately.

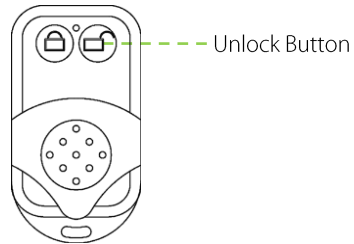
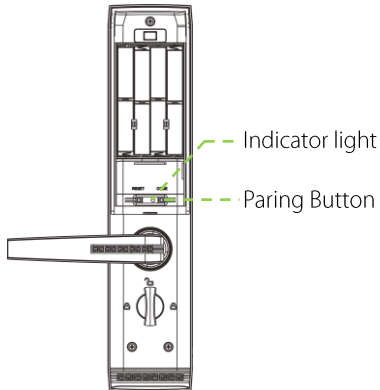

Remote Control Device

● **Operating Steps:**

Press the unlock button on the remote control device, and hold it for 3 seconds to open the door until “Thank you” voice notification is prompted.

- Note:** 1. When lock is powered on, above unlock operation is not available.
2. The valid straight-line distance is up to 10 meters.

● **Register Steps:**

Step 1: Press and hold the pairing button until the indicator light blinks one time.

Step 2: Press the unlock button, the indicator light will keep blinking.

Step 3: Press the pairing button again, the indicator light will turn off.

Step 4: Press the unlock button again, the indicator light will keep fast blinking. When the indicator light stops blinking, the registration is finished.

- Note:** If the remote control device is lost, please press and hold the pairing button to clear all registrations.

Quick Start

Open the Door With Fingerprint

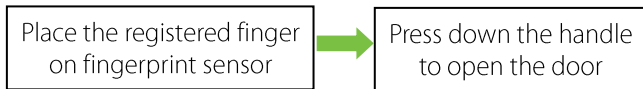

Open the Door With Password

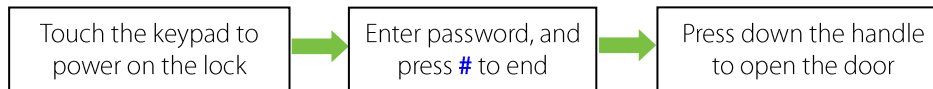

Note: User may enter random password to prevent any person beside you from detecting your password. The maximum length of the random password is 32 digits.

Open the Door With Card





#24, Shambavi Building, 23rd Main, Marenahalli, JP Nagar 2nd Phase, Bengaluru - 560078
Phone : 91-8026090500 | Email : sales@esslsecurity.com
www.esslsecurity.com